

# PRODUCT DATA SHEET

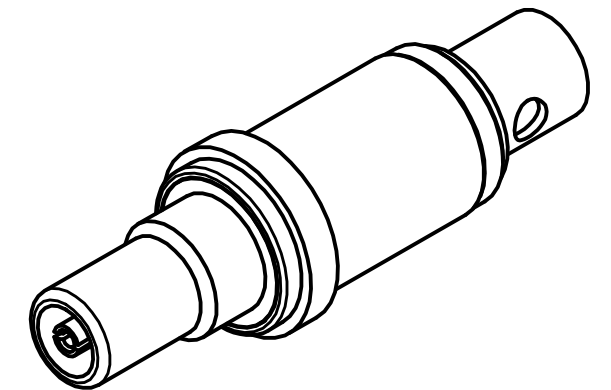
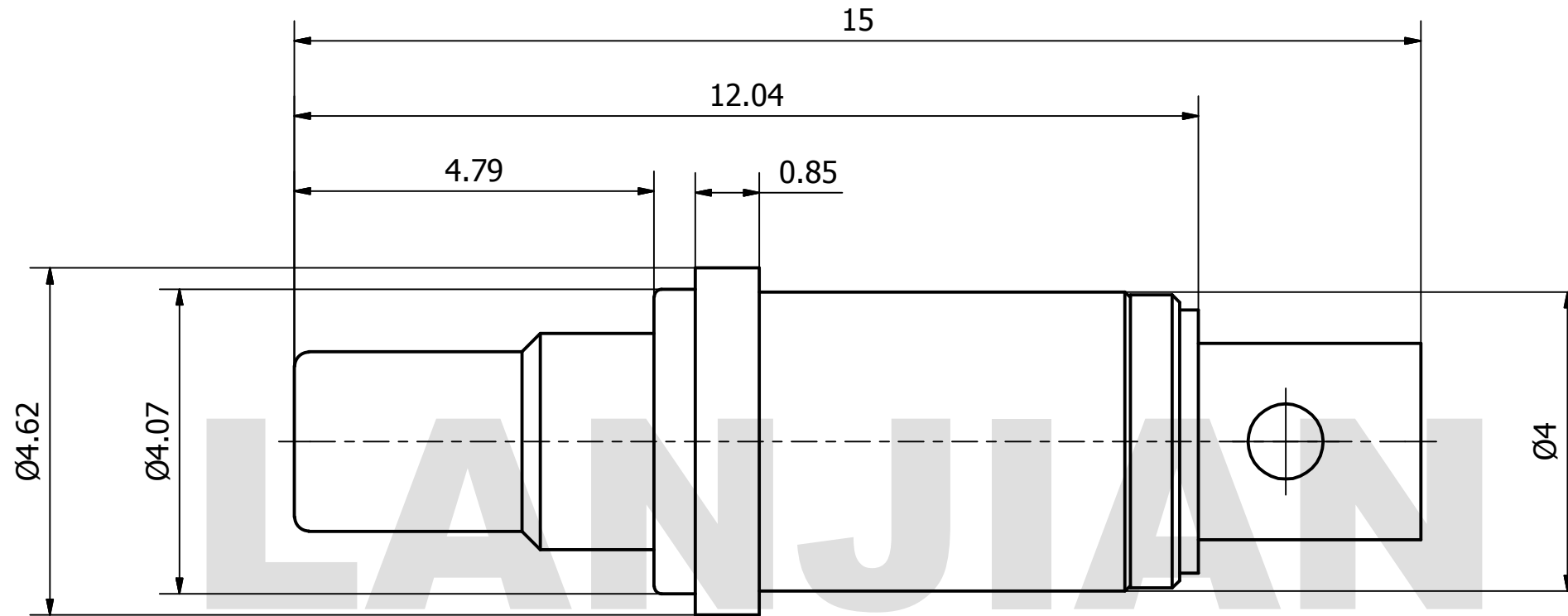

**MATERIAL:**  
 BODY: BRASS  
 CONTACT: BERYLLIUM COPPER PER ASTM B196.  
 ALLOY NO. UNS C17300  
 INSULATOR: PEI

**PERFORMANCE:**  
 IMPEDANCE: 50 OHMS  
 FREQUENCY: DC TO 40 GHz  
 VSWR:  $\leq 1.50$  (TESTING WITH CABLE)

THIS DOCUMENT CONTAINS CONFIDENTIAL AND PROPRIETARY INFORMATION THAT CANNOT BE REPRODUCED OR DIVULGED, IN WHOLE OR IN PART, WITHOUT WRITTEN AUTHORIZATION FROM "LANJIAN ELECTRONICS"

MATERIAL :			
UNLESS OTHERWISE SPECIFIED: DIMENSIONS IN MM			
TOLERANCES :			
X.X	$\pm 0.10$	ANGULAR : $\pm 30'$	DEBURR AND BREAK SHARP EDGES
X.XX	$\pm 0.05$	FILLETS R/C : $\pm 0.10$	
X.XXX	$\pm 0.005$	SURFACE FINISH : Ra 0.8	
	NAME	DATE	SIGNATURE
DRAWN	YaoJiang	12/10/2018	
CHK'D	HongZhongYan	12/10/2018	
APPV'D	HongZhongYan	12/10/2018	
MFG			
PROJECTION		SIZE	SCALE
		A3	12 : 1

<b>LANJIAN ELECTRONICS</b>	
38 Hengtong Road, Xinqu Dingmao Zhenjiang, 212009, Jiangsu, P. R. China	
TITLE	
SMPM-K3506-3 straight jack cable connector	
DWG No.	REV.
GCPZ3.660.H.017	A
DO NOT SCALE THE DRAWING	
PAGE 1 / 1	